

HARDWARE

flight case and cabinet components

ACCESSORI RACK - vers. 12/2013

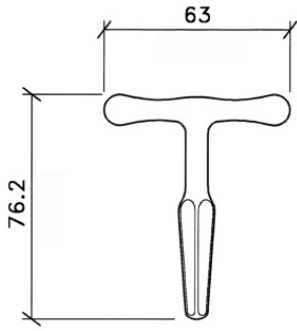

RK2612

Chiave per sportelli

materiale: Acciaio
finitura: Zincato
peso: 80 gr

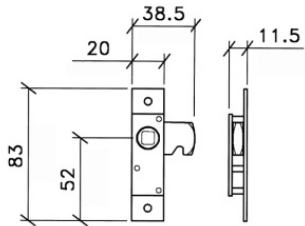

FORI DI FISSAGGIO 4.8mm DIA



RK2602

Chiusura sportelli

materiale: Acciaio/Ottone
finitura: Zincato
peso: 80 gr

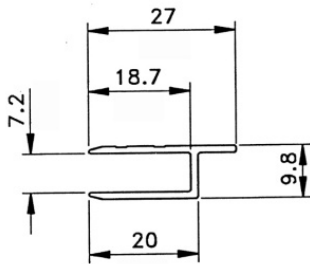

ALP2355

Profilo per coperchi. Chiusura in battuta (per pannelli spessore 7 mm) h=27mm

materiale: Alluminio 20/10 (4 mt)
finitura: Grezzo
peso: 180 gr/mt

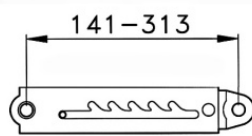

FORI DI FISSAGGIO 5mm DIA



RK1205A

Supporto registrabile 5 posizioni

materiale: Acciaio
finitura: Zincato
peso: 192 gr.

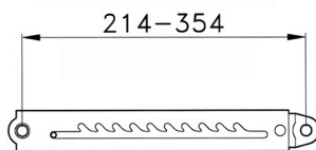

FORI DI FISSAGGIO 5mm DIA



RK1210A

Supporto registrabile a 10 posizioni

materiale: Acciaio
finitura: Zincato
peso: 300 gr.

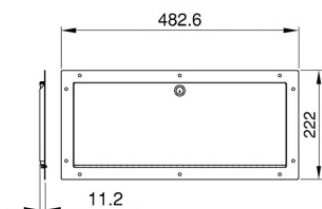

RK2622

Sportello con chiusura a chiave

materiale: Acciaio 12/10

finitura: Nero

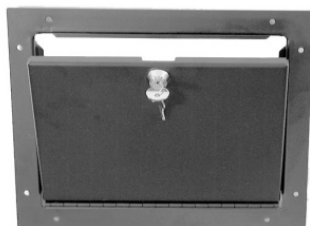
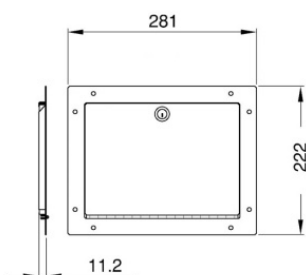

RK2632

Sportello con chiusura a chiave

materiale: Acciaio 12/10

finitura: Nero

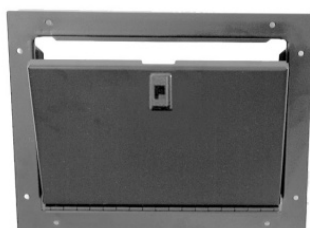
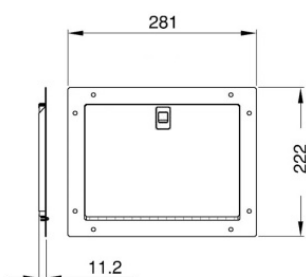

RK2632SL

Sportello con chiusura a scatto

materiale: Acciaio 12/10

finitura: Nero

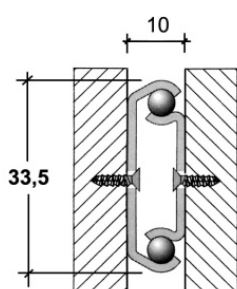

AC7531 - AC7541

Guida telescopica a 2 vie

materiale: Acciaio

finitura: Zincato

peso: kg. 0,740 - 0,920

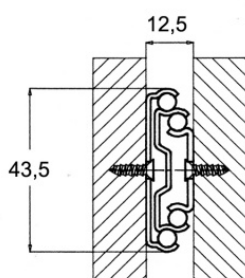

AC7571 - AC7591

Guida telescopica a 3 vie sganciabili

materiale: Acciaio

finitura: Zincato

peso: 1,080 - 1,360 kg