

# **HARDWARE**

**flight case and cabinet components**

**CASTORS - vers. 05/2015**

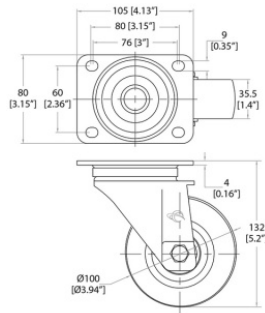

### RT3422SXH

Swivel castor Ø 100 mm. Support high-thickness steel. Core and roller bearings increased

material: Steel  
finish: Zinc

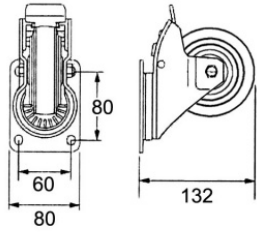

### RT3472SXH

Braked swivel castor, Ø 100 mm. Support high-thickness steel. Core and roller bearings increased

material: Steel  
finish: Zinc

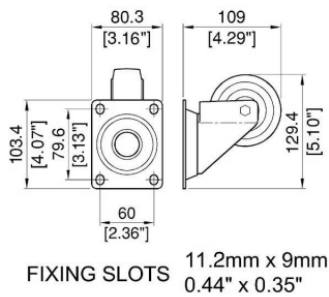

### RT3402SXH

Swivel castor Ø 80 mm. Support high-thickness steel. Core and roller bearings increased

material: Steel  
finish: Zinc



### RT3462SXH

Braked swivel castor, Ø 80 mm. Support high-thickness steel. Core and roller bearings increased

material: Steel  
finish: Zinc

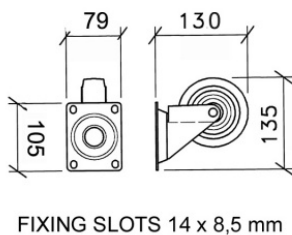

### RT3422SX5

Swivel castor, Ø 100 mm. Steel support. Core in ABS and roller bearings

material: Steel  
finish: Zinc  
weight: 860 gr

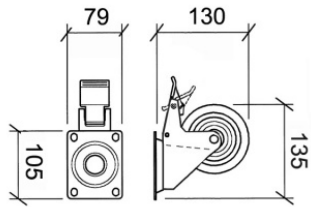

FIXING SLOTS 14 x 8,5 mm



### RT3472SX5

Braked swivel castor, Ø 100 mm.  
Steel support Core in ABS and roller bearings

material: Steel  
finish: Zinc  
weight: 1090 gr

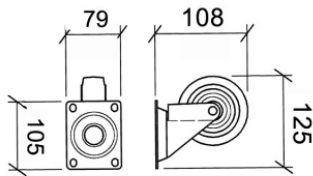

FIXING SLOTS 14 x 8,5 mm



### RT3402SX5

Swivel castor Ø 80 mm. Steel support. Core in ABS and roller bearings

material: Steel  
finish: Zinc  
weight: 664 gr

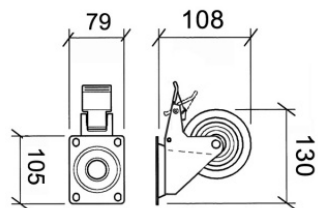

FIXING SLOTS 14 x 8,5 mm



### RT3462SX5

Braked swivel castor, Ø 80 mm.  
Steel support. Core in ABS and roller bearings

material: Steel  
finish: Zinc  
weight: 878 gr

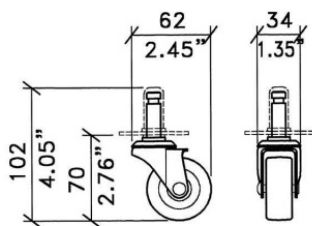

FIXING HOLES 7mm/.27" DIA



### RT3498

Push in castor Ø 50 mm

material: Steel+Rubber  
finish: Zinc  
weight: 230 gr

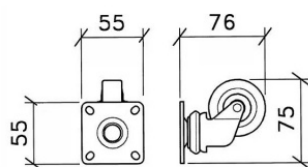

FIXING SLOTS 8 x 6 mm



### RT3432

Swivel castor Ø 50 mm

material: Steel  
finish: Zinc  
weight: 400 gr

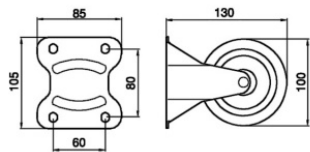

FIXING SLOTS 12 x 9 mm



### RT3452SX5

Fixed castor Ø 100 mm. Steel support. Core in ABS and roller bearings

material: Steel  
finish: Zinc  
weight: 590 gr

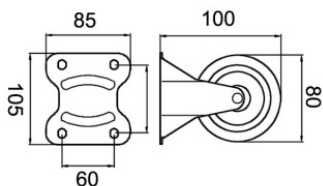

FIXING SLOTS 12 x 9 mm



### RT3442SX5

Fixed castor Ø 80 mm. Steel support. Core in ABS and roller bearings

material: Steel  
finish: Zinc  
weight: 450 gr

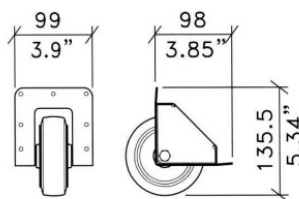

FIXING HOLES 5.0mm / .20" DIA



### RT3496

Recessed castor with Ø 100 mm wheel. Steel support. Core in ABS and roller bearings

material: Steel  
finish: Blue  
weight: 670 gr

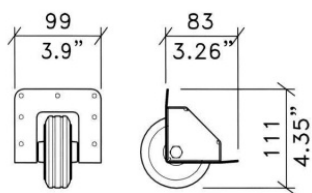

FIXING HOLES 5.0mm / .20" DIA



### RT3494

Steel recessed castor with Ø 75 mm wheel

material: Steel  
finish: Black  
weight: 480 gr

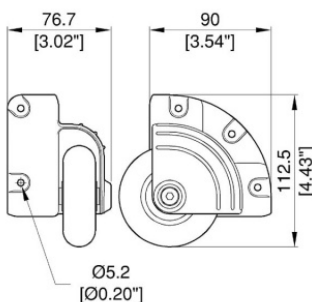

### RT8375

Surface mount corner castor with Ø 75 mm wheel. Outside support

material: Steel/Rubber  
finish: Zinc  
weight: 750 gr

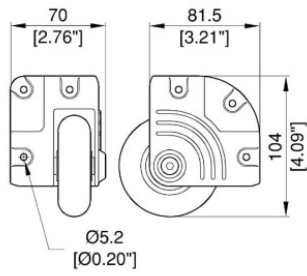

### RT8675

Diecast Corner Castor with  $\varnothing$  75 mm wheel. Inside corner support

material: Steel/Rubber  
 finish: Zinc  
 weight: 750 gr

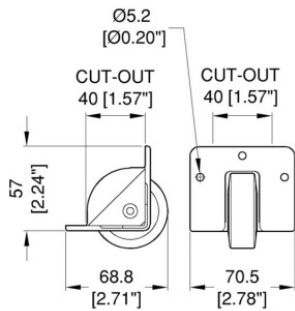

### RT3492

Wheel and Housing  $\varnothing$  50 mm

material: Plastic  
 finish: Black  
 weight: 100 gr

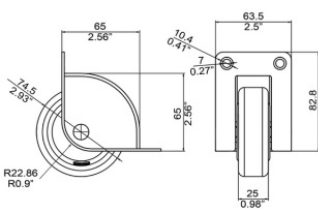

### RT3495

Recessed wheel housing  $\varnothing$  75 mm. Diecast aluminium support

material: Aluminium diecast  
 finish: Black  
 weight: 220 gr

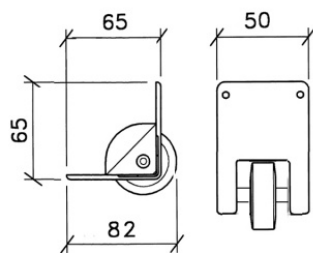

### RT3484

Corner wheel and housing  $\varnothing$  52 mm

material: nylon  
 finish: Black  
 weight: 80 gr

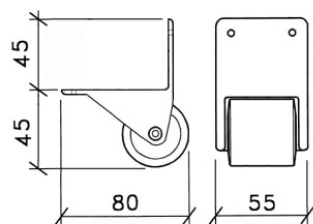

### RT3482

Corner wheel  $\varnothing$ .38 mm

material: Rubber+nylon  
 finish: Black  
 weight: 118 gr

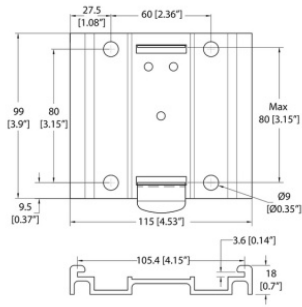

### RT3400SX5

Coupling and uncoupling wheels system, RT34..SX5 series compatible

material: Aluminium/Steel  
 finish: Self colour/zinc steel  
 weight: 680 gr

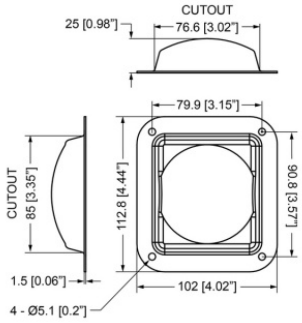

### AC7822

Square recess castor dish

material: Steel  
 finish: Zinc  
 weight: 120 gr

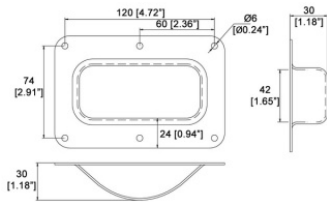

### AC0968

Rectangular recess castor dish

material: Steel  
 finish: Zinc

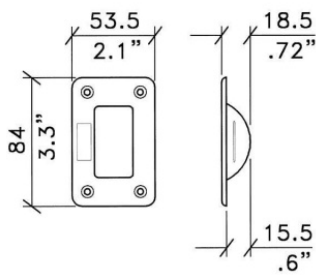

### AC7898

Plastic castor plate

material: Black plastic  
 finish: Nylon  
 weight: 14 gr

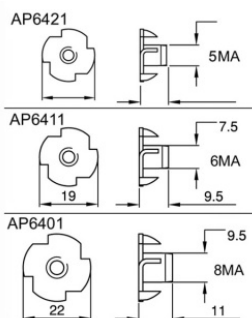

### AP64...

Tee nut

material: Steel  
 finish: Zinc

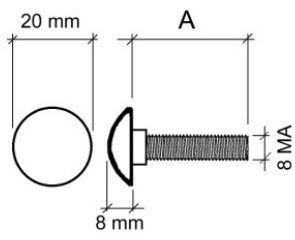

## RXB30S8 - 40S8 - 45S8

Pozi-drive pan head screw

material: Steel

finish: Zinc

weight: 18 - 22 - 24 gr