

# **HARDWARE**

flight case and cabinet components

**HINGES & LID STAYS - vers. 02/2014**

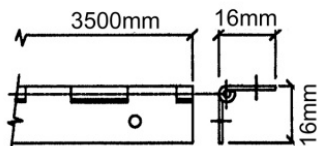

### CR1501

Piano hinge 30 mm. Pin Ø 1.5 mm

material: Steel 8/10 (3.5 mt)

finish: Nickel

weight: 182 gr/mt

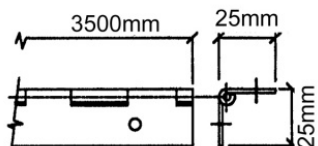

### CR1511

Piano hinge 50 mm. Pin Ø 1.5 mm

material: Steel 8/10 (3.5 mt)

finish: Nickel

weight: 280 gr/mt

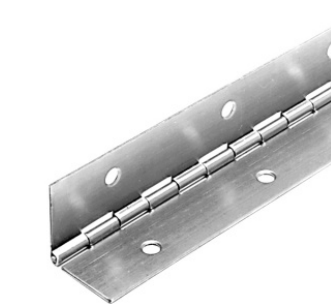
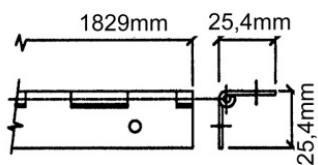

### CR1512B

Piano hinge 50 mm. Pin Ø 3 mm

material: Aluminium 12/10 (1.83 mt)

finish: Self colour

weight: 370 gr/bar

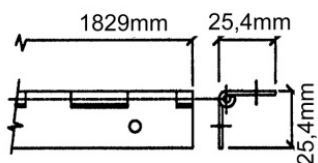

### CR1521B

Piano hinge 50 mm. Pin Ø 3 mm

material: Steel 12/10 (1.83 mt)

finish: Zinc

weight: 1200 gr/bar

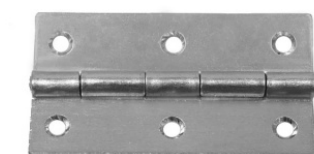
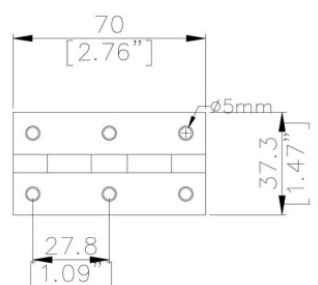

### CR2512

Pre punched hinge 70 x 37,3 mm

material: Steel

finish: Zinc

weight: 450 gr.

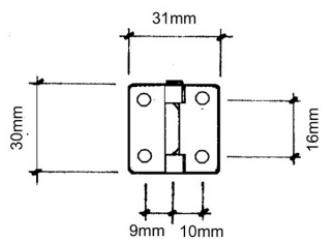

FIXING HOLES Ø 3.5 mm

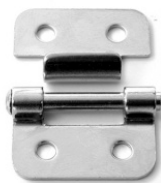

### CR3521

Small lift off hinge

material: Steel 12/10

finish: Nickel

weight: 14 gr

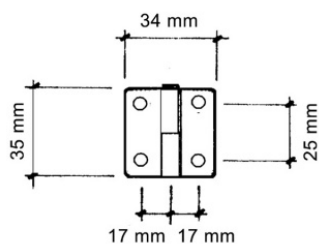

FIXING HOLES Ø 3.5 mm

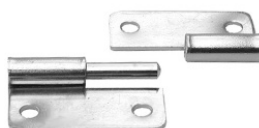

### CR3501

Duty lift off hinge

material: Steel 15/10

finish: Nickel

weight: 20 gr

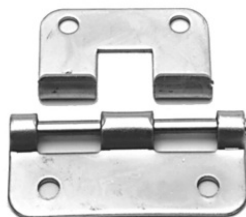
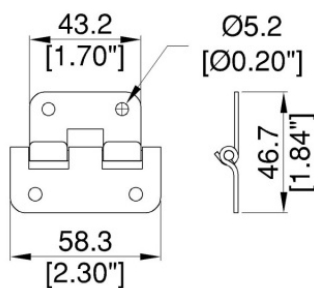

### CR3502

Heavy duty lift off hinge

material: Steel 15/10

finish: Zinc

weight: 40 gr

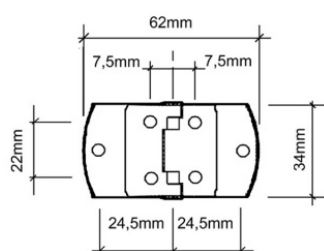

FIXING HOLES Ø 3.5 mm



### CR4501

Strut hinge

material: Steel 15/10

finish: Nickel

weight: 42 gr

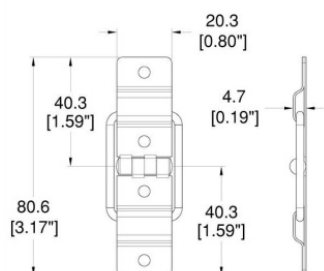

### CR4502

Small strut hinge

material: Steel

finish: Nickel

weight: 25 gr

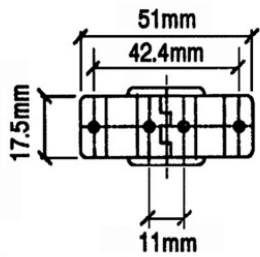

FIXING HOLES Ø 3 mm



### CR4512

Small strut hinge

material: Steel  
finish: Nickel  
weight: 25 gr

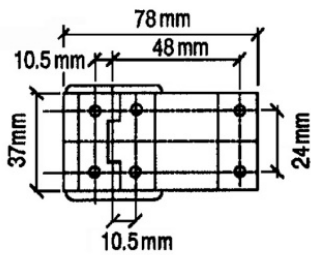

FIXING HOLES Ø 4,5 mm

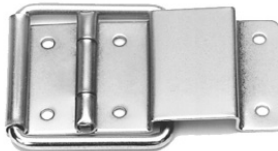

### CR4522

Large chrome strut hinge

material: Steel  
finish: Chrome  
weight: 50 gr

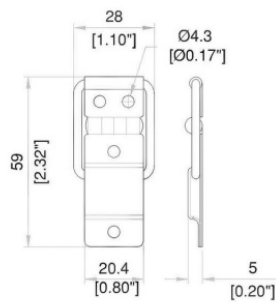

### CR4514

Small strut hinge

material: Steel  
finish: Nickel  
weight: 25 gr

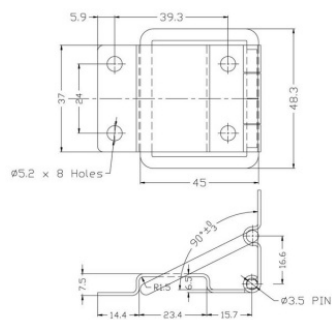

### CR4532

Large chrome strut hinge

material: Steel  
finish: Chrome  
weight: 55 gr

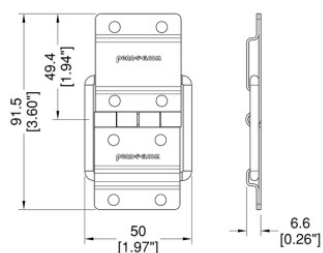

### CR4532H

Large strut hinge

material: Steel  
finish: Zinc  
weight: 55 gr

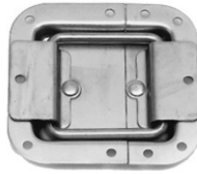
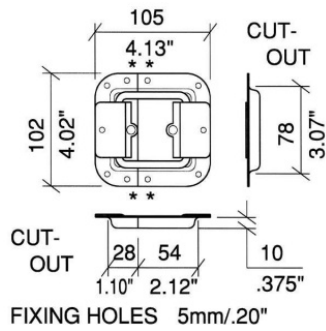

## RG5532

Lid stay with deep dish

material: Steel 12/10  
finish: Zinc  
weight: 210 gr

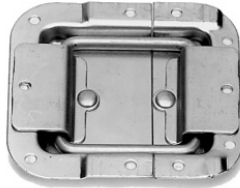
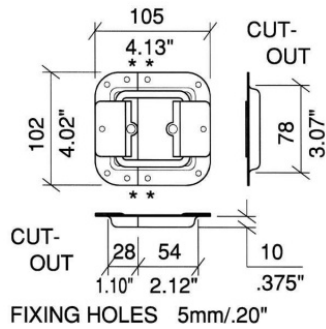

## RG5532S

Lidstay with deep dish with offset for extrusion

material: Steel 12/10  
finish: Zinc  
weight: 210 gr

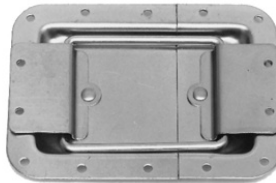
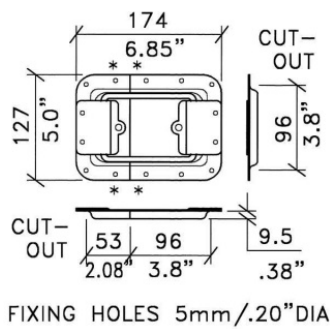

## RG5522

Large lid stay with deep dish

material: Steel 15/10  
finish: Zinc  
weight: 390 gr

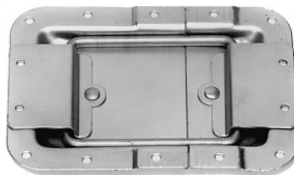
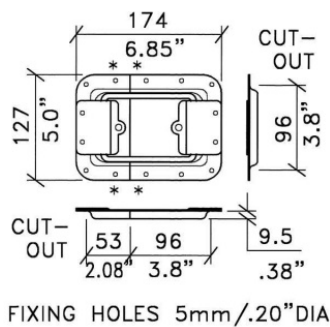

## RG5522S

Large lid stay with deep dish with offset for extrusion

material: Steel 15/10  
finish: Zinc  
weight: 390 gr

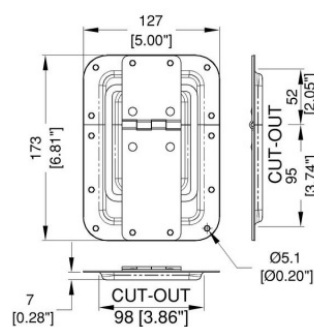

## RG5542

Large recessed hinge with lid stay

material: Steel  
finish: Zinc  
weight: 420 gr

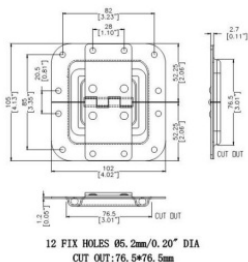

## RG5552

Medium recessed hinge with lid stay

material: Steel  
finish: Zinc  
weight: 370 gr

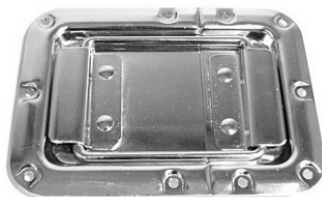
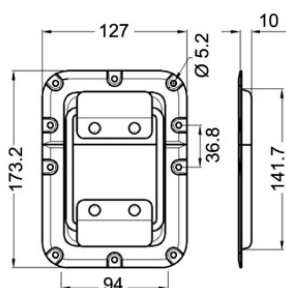

## RG5562

Large lid stay with deep dish

material: Steel  
finish: Zinc  
weight: 390 gr

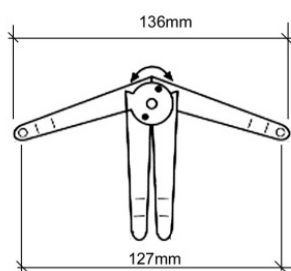

## RG5541

Lid stay for suitcases

material: Steel 15/10  
finish: Nickel  
weight: 24 gr

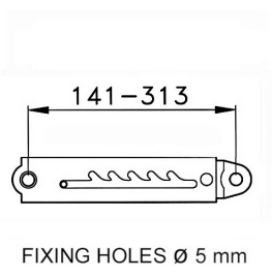

## RK1205A

Adjustable ratchet stay 5 stops

material: Steel  
finish: Zinc  
weight: 192 gr.

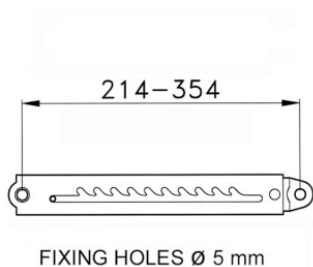

## RK1210A

Adjustable ratchet stay 10 stops

material: Steel  
finish: Zinc  
weight: 300 gr.

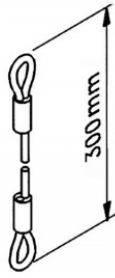

### RG5571

114 wires lid stay. Length 30cm

material: Steel

finish: Zinc

weight: 14 gr