

# **HARDWARE**

**flight case and cabinet components**

**RACE CASE SYSTEM - vers. 02/2014**

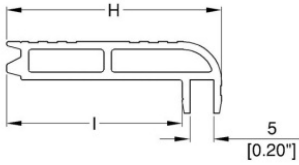

PART	H	I
SE3023BAS	23 / 0.9"	14.8 / 0.58"
SE3030BAS	30 / 1.18"	21.8 / 0.86"
SE3045BAS	45 / 1.77"	36.8 / 1.45"
SE3080BAS	80 / 3.14"	71.8 / 2.83"
SE3114BAS	113.6 / 4.47"	105.4 / 4.15"

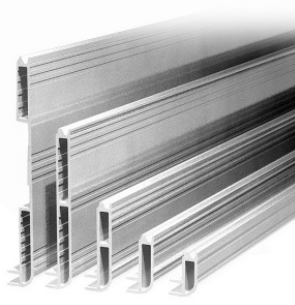

### SE3...BAS

Base maker extrusion (panel thickness 5 mm) h=23-114 mm

material: Aluminium (4mt)  
finish: Silver Anodised

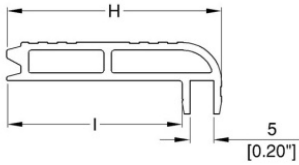

PART	H	I
SE3023LAS	23 / 0.9"	14.8 / 0.58"
SE3030LAS	30 / 1.18"	21.8 / 0.86"
SE3045LAS	45 / 1.77"	36.8 / 1.45"
SE3080LAS	80 / 3.14"	71.8 / 2.83"
SE3114LAS	113.6 / 4.47"	105.4 / 4.15"

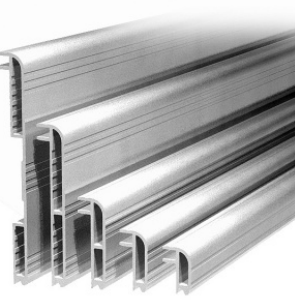

### SE3...LAS

Lid maker extrusion (panel thickness 5 mm) h=23-114 mm

material: Aluminium (4mt)  
finish: Silver Anodised

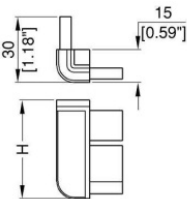

Corner	H
SC2023BK	23mm / 0.9"
SC2030BK	30mm / 1.18"
SC2045BK	45mm / 1.77"
SC2080BK	80mm / 3.15"
SC2114BK	114mm / 4.49"

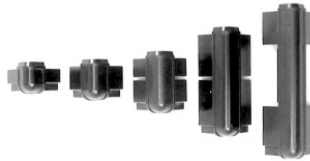

### SC2...BK

Plastic corners. To suit SE3...BAS base maker extrusions

material: Plastic  
finish: Black

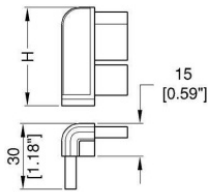

Corner	H
SC2023L K	23mm / 0.9"
SC2030L K	30mm / 1.18"
SC2045L K	45mm / 1.77"
SC2080L K	80mm / 3.15"
SC2114L K	114mm / 4.49"



### SC2...LK

Plastic corners. To suit SE3...LAS lid maker extrusions

material: Plastic  
finish: Black

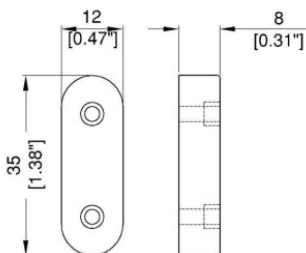

FIXING HOLES 3.2mm/.126"



### PL2902

Plastic feet 2 fixing holes

material: Plastic  
finish: Black  
weight: 3 gr

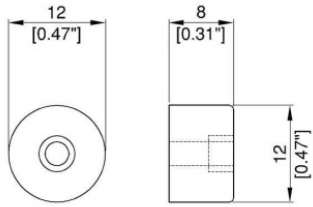

FIXING HOLES 3.2mm/.126"

### PL2912

Small plastic foot

material: Plastic  
 finish: Black  
 weight: 3 gr

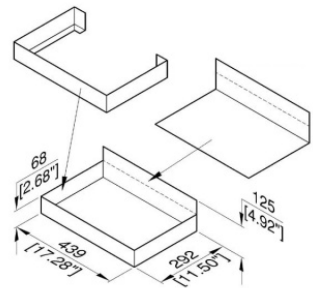

### RZTS70FB

Pre-formed brief case insert to suit SE3080BAS extrusion

material: Self-sticking padded TNT

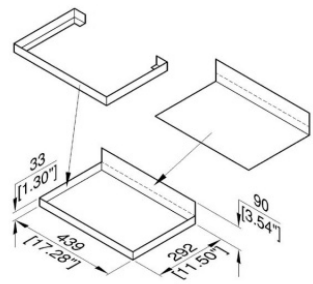

### RZTS35FB

Pre-formed brief case insert to suit SE3045BAS extrusion

material: Self-sticking padded TNT

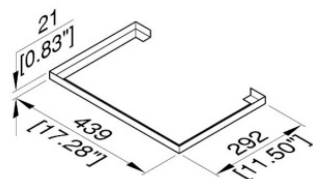

### RZTS21F

Finiture

material: Self-sticking padded TNT

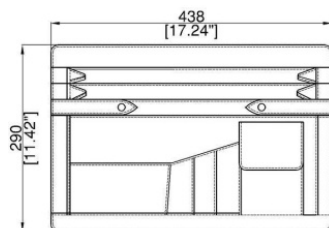

### RYPRD22

Briefcase insert

material: Cardboard fiber+Woven no woven  
 finish: Black  
 weight: 545 gr



### SX0..400 - 500 - 600

Two part epoxy adhesive



### RVNX720

Pneumatic crimping

material: Steel