

# **HARDWARE**

**flight case and cabinet components**

**STAINLESS STEEL - vers. 02/2014**

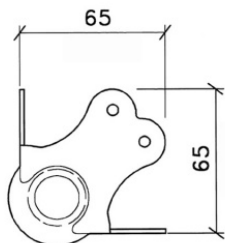



FIXING HOLES Ø 5 mm



### CN2212SS

Heavy duty ball corner, stackable

material: Stainless steel 15/10

finish: Bright

weight: 90 gr

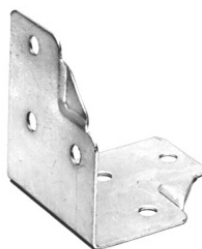
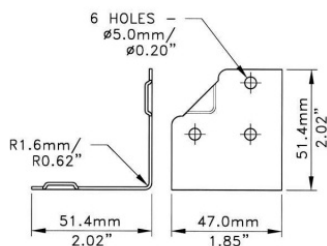

### RN5282SS

Medium brace 6 holes with offset for extrusions

material: Stainless steel 12/10

finish: Bright

weight: 40 gr

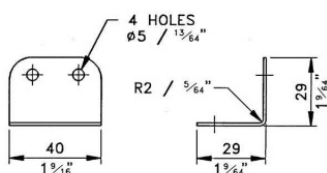

### RN5242SS

Medium brace 4 holes

material: Stainless steel 12/10

finish: Bright

weight: 20 gr

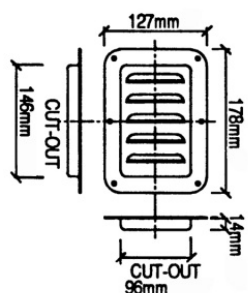

### AC7412SS

Large dish vertical louvre

material: Stainless steel 12/10

finish: Bright

weight: 236 gr

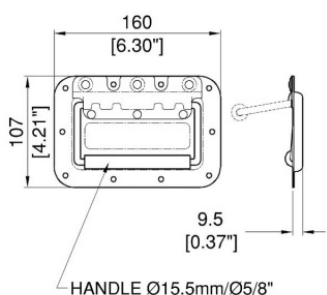

### MN1404SS

Recessed flip handle

material: Stainless steel 12/10

finish: Bright

weight: 330 gr